

Seabourn Odyssey Seabourn Sojourn Seabourn Quest

DECK PLANS

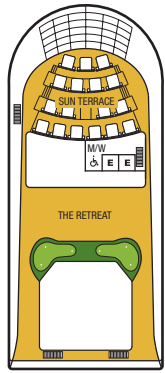

DECK 11

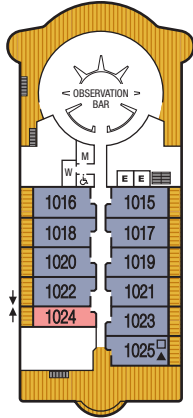

DECK 10

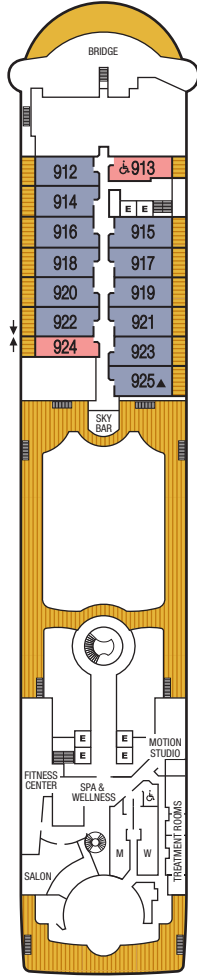

DECK 9

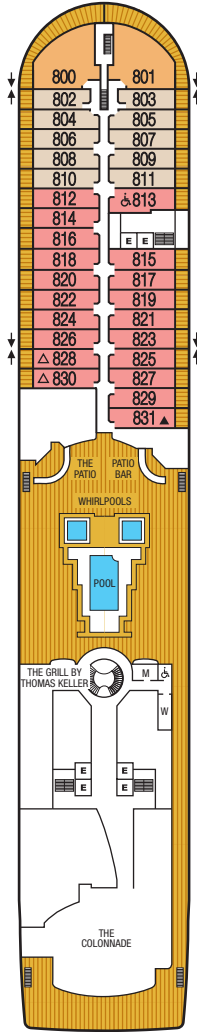

DECK 8

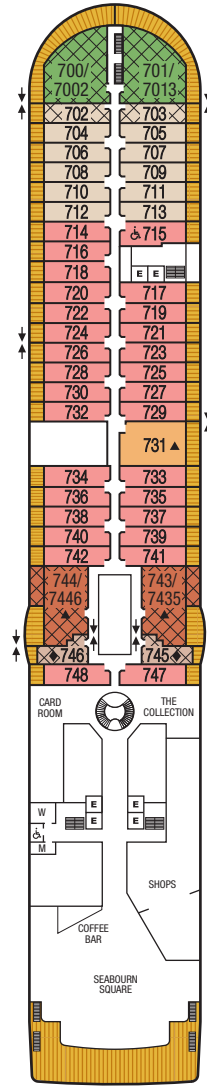

DECK 7

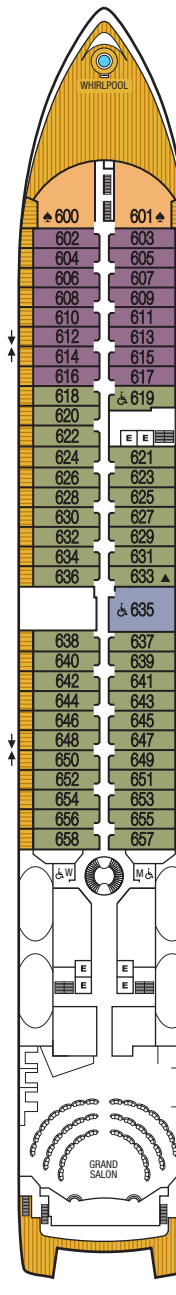

DECK 6

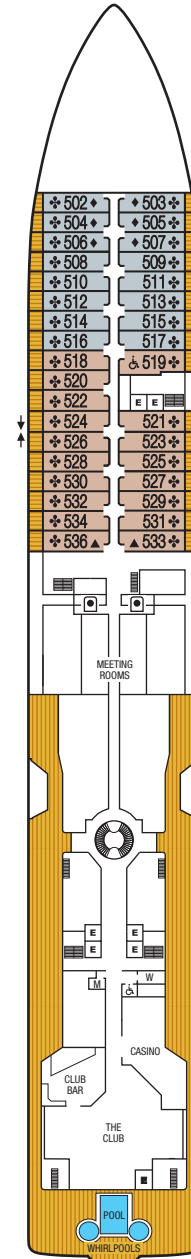

DECK 5

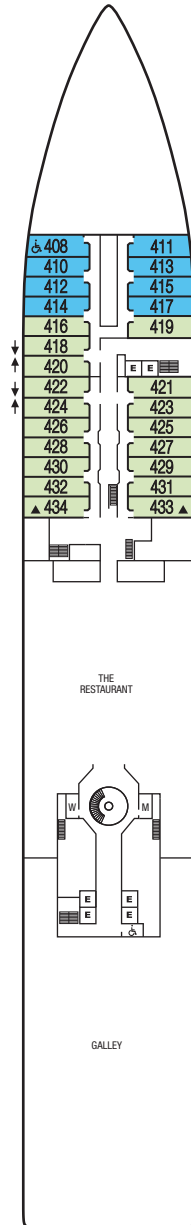

DECK 4

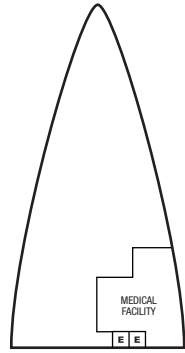

DECK 3

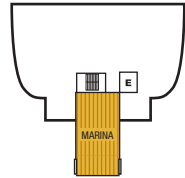

DECK 2

Connecting Suites

When combining the following suites, their suite numbers change as follows:
 Suites 701 and 703 become Grand Signature Suite 7002;
 suites 701 and 703 become Grand Signature Suite 7013;
 suites 743 and 745 become Grand Wintergarden Suite 7435;
 suites 744 and 746 become Grand Wintergarden Suite 7446.

Wheelchair Accessible Suites

Suites 408, 519, 619, 635, 715, 813 & 913 are wheelchair accessible—roll-in shower only, wheelchair-accessible doorways. Suite 635 also has a tub.

- ♣ Suites 600 and 601 are subject to noise when anchoring and the veranda railings are part metal and part glass from floor to teak rail.
- △ Suite 828 third guest capacity for Seabourn Sojourn only
- △ Suite 830 third guest capacity for Seabourn Odyssey and Seabourn Quest only
- ▲ Third Guest Capacity Suite
- Elevator

- ☐ Self Service Launderette
- ◆ Suites 502–507 and 745–746 have smaller verandas
- Suite 1025 has a partially obstructed veranda view
- ♣ The veranda railings in categories V1 and V2 are part metal and part glass from floor to teak rail
- ❖ Suites 1090, 1091, 1092, & 1093 are only accessible via a staircase

Deck plan shown is for illustration purposes. Seabourn reserves the right to make amendments and changes. Effective 3/26/19.

SUITE CATEGORIES

| | | | | | | |
|----|----|----|----|----|----|----|
| GR | WG | SS | OW | PS | PH | V6 |
| V5 | V4 | V3 | V2 | V1 | A1 | A |

